

# Documentation Centre

## Permanent Exhibition

The three-part exhibition in the Memorial's Documentation Centre, which opened in 2007, explains the history of the Bergen-Belsen, Fallingb., Oerbke and Wietendorf POW camps (1939–1945) as well as Bergen-Belsen's history as a concentration camp (1943–1945) and displaced persons camp (1945–1950). The exhibition features numerous documents, photographs, films and artefacts from national and international archives, private owners and the Memorial's own extensive collection. The perspectives of victims and survivors are represented throughout the exhibition through diaries, letters, drawings, personal accounts and witness interviews. Short explanatory texts on the wall panels place these sources in a historical context.

## Video Points

The video points show 45 films which were assembled for the exhibition from a collection of more than 400 biographical interviews. The free-standing biographical video points cover content relating to the adjacent parts of the exhibition. Most of the thematic video points, by contrast, are integrated into the exhibition display cases and are therefore directly incorporated in the overall narrative. These films feature several witnesses talking about a particular subject.

## Supplementary Levels

Each section of the exhibition has an area which offers visitors more extensive supplementary information: computer terminals and binders with documents, commentary and biographies of nearly everyone mentioned in the exhibition.

## Ground floor

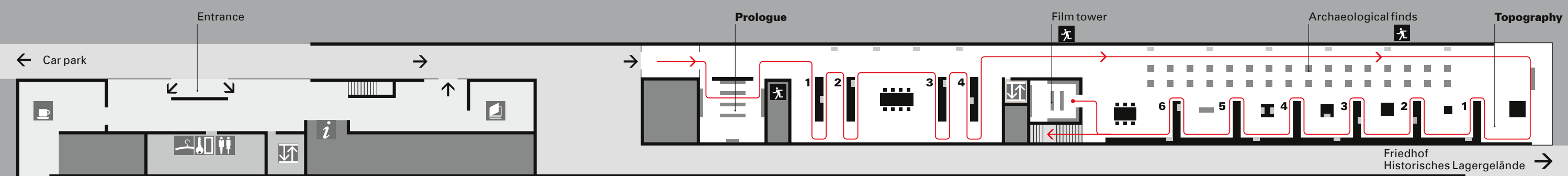

- Supplementary levels
- Video point
- Display case
- Bench
- Tour

### Wehrmacht POW Camp 1939–1945

### Bergen-Belsen Concentration Camp 1943–1945

- 1, 2** Soviet POWs 1941–1942
- 3** Soviet POWs 1942–1945  
Italian military internees 1943–1945
- 4** Warsaw Uprising participants 1944–1945  
End of war and liberation 1945
- 6** Liberation
- 5** Photos by British liberators – Documentation of the crimes
- 4** Bergen-Belsen as “reception” camp and camp for the dying December 1944 – April 1945
- 3** Men’s and women’s camps 1944–1945
- 1, 2** Bergen-Belsen exchange camp 1943–1945

## Upper floor

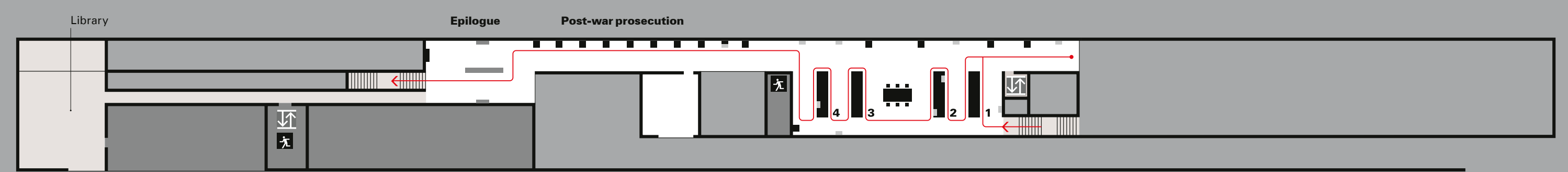

- 2, 3, 4** Jewish DP camp 1945–1950
- 1** Emergency hospital 1945  
Polish DP camp 1945–1946



## Documentation Centre

Open daily  
 April to September 10 a.m. – 5 p.m.  
 October to March 10 a.m. – 4 p.m.  
 The Documentation Centre is closed over the New Year period. The precise dates can be found on our website. Entry is free of charge.

## Book Shop

The book shop is open during the Documentation Centre's opening hours and offers a diverse selection of accounts and witness reports in different languages.

## Library

Monday, Tuesday and Thursday  
 10.30 a.m. – 4.30 p.m.  
 and by appointment

## Cafeteria

April to September 10 a.m. – 5 p.m.  
 October to March 10 a.m. – 4 p.m.

## Accessibility

All public areas of the Documentation Centre are wheelchair-accessible. Wheelchairs can be borrowed from the Information Desk.

## Video and Photographs

To protect light-sensitive documents, please do not use flash photography in the exhibition. Commercial or journalistic photographs may only be taken with prior approval.

Bergen-Belsen Memorial  
 Anne-Frank-Platz  
 29303 Lohheide  
 Germany  
 Tel. + 49 (0)5051 4759-0  
 Fax. + 49 (0)5051 4759-118  
 bergen-belsen@stiftung-ng.de  
 www.bergen-belsen.de

# Cemetery Historical Grounds of the Camp

## The Cemeteries

Between 1941 and 1945, more than 70,000 people died in the Bergen-Belsen POW and concentration camp. Many victims of the concentration camp were buried in mass graves in the grounds of the former camp after the liberation in April 1945. There are currently 13 mass graves and 15 individual graves here. Nearly 20,000 victims of the Bergen-Belsen POW camp are buried in the Hörsten cemetery around 600 metres from the site of the former camp.

## The Historical Grounds of the Camp

The current Memorial encompasses the entire historical grounds of the former camp. A stony path leads from the Memorial's forecourt to the geographic centre of the former camp. At the end of this path, in the middle of a swath of lawn, there are two relief models showing the camp's topography from September 1944 and the current grounds of the Memorial. Landscaping elements have made the structures of the former camp "decipherable" again here. Clearings in the forest trace the boundaries of the former camp and mark the sites of buildings.

## Markers

The individual sections of the camp are marked by nine additional relief models along the edges of the lawn tracing the camp's former main street. Short texts explain the former use of each section.

## Information Pillars

Pillars located at historically significant sites throughout the grounds provide information on other aspects of the former camp's history. At many of these sites, structural remains from the time of the camp have been preserved, such as floors and foundations, paved paths, fire water basins and latrine shafts.



- Mass graves
- Individual graves
- Individual graves designed to harmonize with mass graves
- Remains of camp structures
- Sites of camp structures from September 1944 (not preserved)
- Paths, largely wheelchair-accessible
- Meadows to reach forest clearings, not wheelchair-accessible
- Bench

- A** Documentation Centre with exhibition on history of the site, documents office, information desk, library, book shop, cafeteria
- B** Educational centre, seminar and event rooms, special exhibitions, administration

- Monuments/memorials**
- 1 Polish wooden cross (1945)
  - 2 Jewish monument (1946)
  - 3 Obelisk and inscription wall (1952)
  - 4 House of Silence (2000)
  - 5 Soviet monument (1945)
  - 6 German memorial stone (1968)
  - Memorial stones

- X** Relief models of the camp from 1944 and the current Memorial
- Markers**
- L1** Entrance section/SS administration
- L2a** POW Camp
- L2b**
- L3** Neutrals' Camp
- L4** Special Camp/ Hungarians' Camp
- L5** Star Camp
- L6** Women's camp
- L7** Men's camp
- L8** SS clothing store

- Information pillars**
- S1** Camp perimeter
- S2** Roll-call square for star camp
- S3** Main camp street
- S4** Huts 9 and 10
- S5** Latrine huts
- S6** SS swimming pool
- S7** Main camp entrance
- S8** Disinfection building and central baths
- S9** Gate to concentration camp prisoner section administration area
- S10** Camp dividing lines
- Guard tower
- S11** Fire water basin, food depot
- S12** Kitchen D
- Huts 196 – 205
- S13** Fire water basin
- S14** Camp street in POW field hospital
- Huts
- S15** Path to POW cemetery
- "Bier square" in the POW camp
- S16** Crematorium
- S17** Cemetery in the grounds of the former camp



The cemetery and historical grounds of the Bergen-Belsen Memorial are protected by the German Federal Law on the Preservation of the Graves of the Victims of War and Tyranny. The Lower Saxony Memorials Foundation is responsible for the design and maintenance of the grounds. Please ensure that your conduct and attire are in keeping with the dignity of the site. Bear in mind that people come here to remember their family members.